

ProPEX® Brass Swivel Faucet Adapter

Submittal Information
Revision A: Feb. 1, 2008

Project Information

Job Name:

Location:

Engineer:

Contractor:

Manufacturer's Representative:

Part No. Ordered:

Date Submitted:

Submitted By:

Approved By:

Technical Data

Nut:	Brass/Plastic
PEX Barb:	360 Brass
Nose Cone:	Buna N

Product Information and Application Use

ProPEX® Brass Swivel Faucet Adapters are available for use in hot and cold domestic potable water systems.¹ The end of the adapter is manufactured with the Uponor ProPEX fitting for connections to Wirsbo AQUAPEX® tubing. The Swivel Faucet Adapter is 1/2" or 3/8" ProPEX by 1/2" NPSM for connecting to a male NPSM faucet.

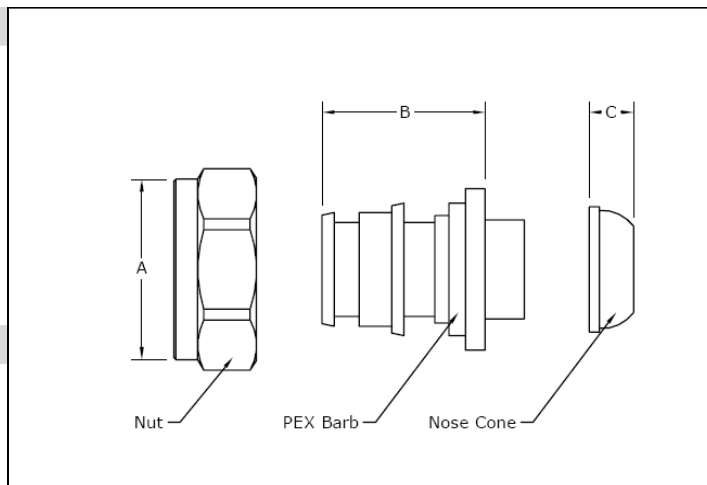

✓ Description

	Part Number	A	B	C	Weight
ProPEX Brass Swivel Faucet Adapter, 3/8" PEX x 1/2" NPSM	Q4653850	0.99"	0.87"	0.26"	0.10 lbs.
ProPEX Brass Swivel Faucet Adapter, 1/2" PEX x 1/2" NPSM	Q4655050	0.99"	0.98"	0.26"	0.10 lbs.
ProPEX Brass Swivel Faucet Adapter with plastic nut, 3/8" PEX x 1/2" NPSM	Q2120375	1.16"	0.87"	0.26"	0.02 lbs.

Installation

Use the appropriate Uponor ProPEX Ring for the tubing. Refer to the AQUAPEX Professional Plumbing Installation Handbook or the Uponor Radiant Installation Handbook for additional information.

Standards

CAN/CSA B137.5; ASTM F877; ASTM F1960

Codes

IPC; UPC; NSPC; NPC of Canada

Listings

HUD MR 1269; ICC ESR 1099; ANSI/NSF 14- and 61-certified; IAPMO 3558

Related Applications

PEX-a Plumbing Systems
Radiant Heating and Cooling Systems

Contact Information

Uponor, Inc.
5925 148th Street West
Apple Valley, MN 55124 USA
Phone: (800) 321-4739
Fax: (952) 891-2008
www.uponor-usa.com

Uponor Ltd.
655 Park Street
Regina, SK S4N 5N1 CANADA
Phone: (888) 994-7726
Fax: (800) 638-9517
www.uponor.ca

¹ProPEX® is a registered trademark of Uponor, Inc. ProPEX™ is a trademark of Uponor Ltd.